



FEDEX: 777398099779

October 5, 2016

Mr. Christopher Ralston
Maryland Department of the Environment
Remediation Division, Oil Control Program
1800 Washington Blvd., Suite 620
Baltimore, Maryland 21230

RE: Monitoring Well Installation Work Plan – MW-189D
Inactive Exxon Facility #28077
14258 Jarrettsville Pike
Phoenix, Baltimore County, Maryland
MDE Case # 2006-0303-BA2

Dear Mr. Ralston:

Kleinfelder, on behalf of ExxonMobil Environmental Services Company (ExxonMobil), submits this Work Plan for the installation of a new groundwater monitoring well (MW-189D) along the Southside Avenue private drive between the MW-82 monitoring well cluster and the private supply well at 3627A Southside Avenue (**Figure 1**).

As discussed with the Maryland Department of the Environment (MDE) during a meeting on July 21, 2016, one additional monitoring well at this location is expected to resolve a data gap identified in the Conceptual Site Model¹ and aid in determining whether or not a potential migration pathway exists between 3627A Southside Avenue and the 2006 release from the former Exxon station at 14258 Jarrettsville Pike. This location would augment existing distal C-zone monitoring wells in the area (MW-78C and MW-133C) (**Figure 1**), enhancing the data density, and could be converted to a recovery well if necessary.

¹ Kleinfelder, July 15, 2016, Conceptual Site Model, Inactive Exxon Facility #28077, 14258 Jarrettsville Pike, Phoenix, MD, MDE Case No. 2006-03-03-BA2, MDE Facility I.D. No. 12342.

NEW MONITORING WELL MW-189D

One monitoring well (MW-189D) is proposed adjacent to the west side of the shared Southside Avenue private drive, on the property belonging to 3605A Southside Avenue.

The total depth of the proposed well will be approximately 384 ft-bgs, equivalent to the bottom elevation of the supply well at 3627A Southside Avenue.

3627A supply well surface elevation = 547 ft-msl

Well depth = 405 ft-bgs

3627A supply well bottom elevation = 142 ft-msl

Proposed new well surface elevation = 526 ft-msl

Target depth = Proposed new well surface elevation – 3627A supply well bottom elevation, or 526 ft-msl – 142 ft-bgs = 384 ft-bgs

This monitoring well is designed as an open-hole bedrock well with 6-inch diameter steel casing installed to approximately 35 feet below ground surface (ft-bgs). This casing length was determined by the depth of the shallowest detection of contamination in MW-138D. The casing is designed to terminate at least 10 feet above the elevation of the shallowest impact detected in MW-138D.

MW-138D top-of-casing elevation = 572.71 feet above mean sea level (ft-msl)

Depth to shallowest impact detected via FLUTE™ sampling = 95 ft-bgs

Elevation of shallowest impact in MW-138D = 572.71-95, or 477.71 ft-msl

Elevation in new well equivalent to shallowest contamination in MW-138D = surface elevation – MW-138D shallowest impact elevation, or 526 ft-msl – 477.71 ft-msl = 48.29 ft

The proposed monitoring well location map is available as **Figure 1**.

FIELD PROCEDURES

Proposed field work is subject to access approvals from property owners prior to commencement. The proposed monitoring well will be open-hole with casing grouted in place from ground surface to the top of designated open interval. Drill cuttings generated during monitoring well installation will be screened in the field using a photo-ionization detector (PID), and cuttings will be collected with a sieve, washed to remove fine particles from drilling, and placed in sample jars for lithologic description.

After drilling activities are complete, and groundwater in the wells equilibrates, gauging measurements will be collected using an electronic interface probe. Well development procedures will include purging of the proposed monitoring wells and collection of field parameter measurements, including specific conductivity, oxidation reduction potential, pH, turbidity, and temperature. Purging will continue until all parameters stabilize or until turbidity is visually clear. Should the groundwater recharge rate be limited, development will be limited to a single purge volume.

BOREHOLE GEOPHYSICAL SURVEYS

Following installation of the new monitoring well, a borehole geophysical survey is proposed. Complete open borehole logging will be conducted, and will include the following tests:

- 3-Arm Caliper, which mechanically measures the borehole diameter;
- Fluid Temperature;
- Fluid Conductivity;
- Acoustic Caliper and High Resolution Acoustic Borehole Televierer, which record an accurately-scaled image of the borehole wall allowing identification of fracture locations;
- Optical Borehole Televierer, which records an accurately-scaled image of the borehole wall allowing identification of features such as fractures and solution openings and semi-quantitative estimation of fracture orientation and thickness using visible light; and
- Heat Pulse Flowmeter, which records the rate of vertical water flow at depth intervals in a borehole.

Following geophysical surveying, groundwater samples will be collected from this monitoring well via HydraSleeve™ samplers set at discrete intervals in the water column on a monthly basis for three months. Sampling intervals will be determined by analysis of the geophysical survey results. Upon receipt of the initial monthly sampling data, a longer-term sampling frequency will be proposed to the MDE for its review and approval.

The first round of groundwater samples will be submitted to the laboratory for analysis of full list VOCs and five oxygenates according to U.S. EPA SW-846 Method 8260B. Subsequent sampling events will be submitted to the laboratory for analysis of MTBE, benzene, toluene, ethylbenzene, and total xylenes (BTEX), tert butyl alcohol (TBA), di-isopropyl ether (DIPE), tert-amyl methyl ether (TAME), and ethyl tert-butyl ether (ETBE) according to U.S. EPA SW-846 Method 8260B.

REPORTING

Groundwater analytical results will be provided, as they are received, reviewed and compiled, in the data summary tables which are transmitted to the MDE monthly by electronic mail and in the standard quarterly reports. In addition, following the completion of the activities proposed in this work plan, the overall results will be submitted to the MDE in a letter report, including descriptions of the activities conducted, collected data, well construction logs, geophysical logs, and recommendations for future activities, as applicable.

CLOSING

Upon approval from the MDE, Kleinfelder will initiate the scope of work described above. MDE will be notified at least five business days in advance of commencing field work.

Please contact the undersigned with any questions or requests for additional information at 410.850.0404.

Sincerely,

KLEINFELDER



Stacey E. Schiding
Project Manager



Mark J. Schaaf, C.P.G.
Project Director

FIGURE

1 Proposed Well Location Map

TABLE

1 Private Supply Well Analytical Data Table: 3627A Southside Avenue

cc: Mr. John J. Hoban – ExxonMobil (Kleinfelder file)
Ms. Ellen Jackson – Maryland Department of the Environment
Mr. Andrew Miller – Maryland Department of the Environment

FIGURE

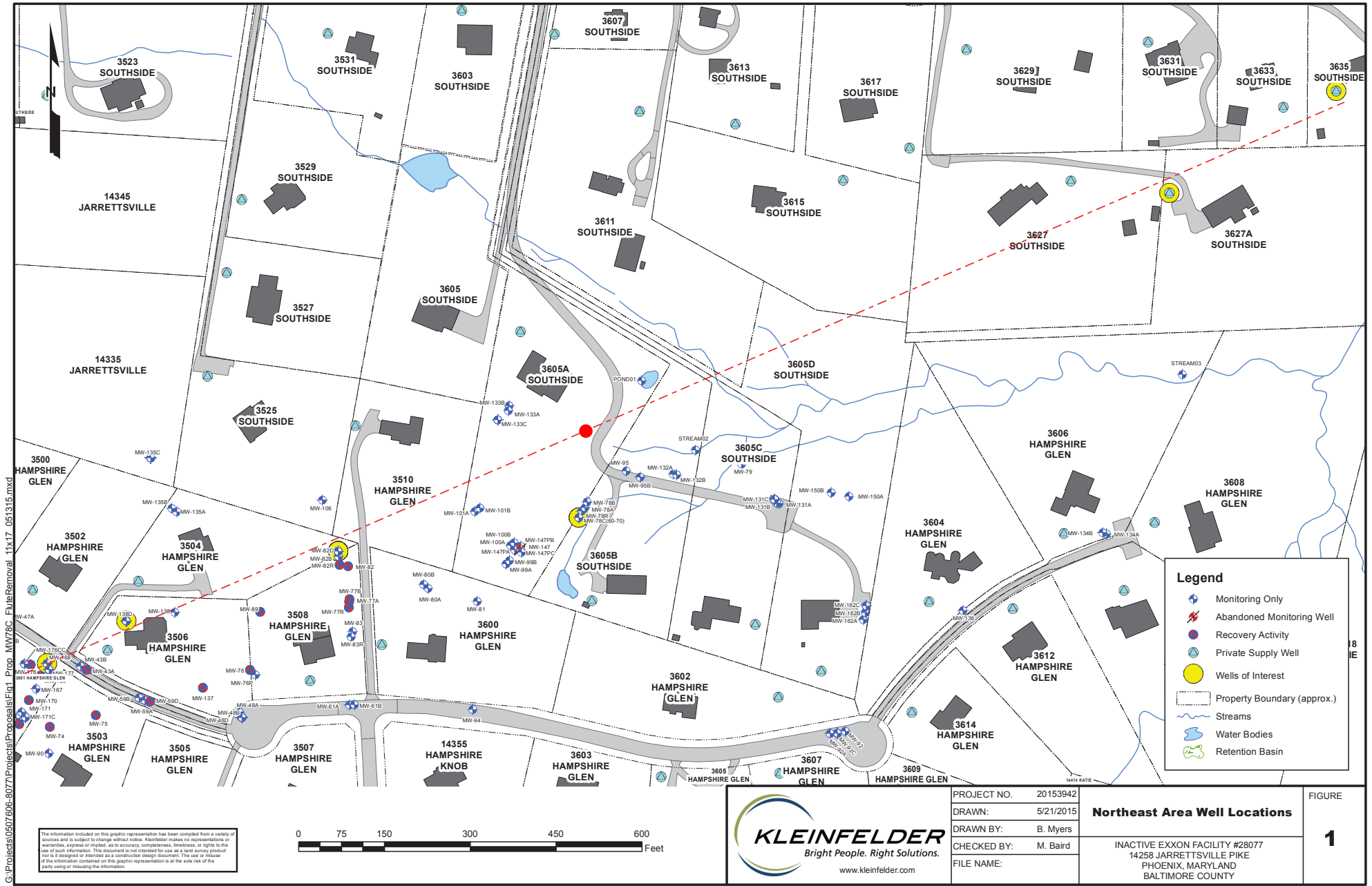

Legend

- Monitoring Only
- Abandoned Monitoring Well
- Recovery Activity
- Private Supply Well
- Wells of Interest
- Property Boundary (approx.)
- Streams
- Water Bodies
- Retention Basin

The information included on this graphic representation has been compiled from a variety of sources and is subject to change without notice. Kleinfelder makes no representations or warranties, express or implied, as to accuracy, completeness, timeliness, or rights to the use of such information. This document is not intended for use as a land survey product nor is it designed or intended as a construction design document. The user of this information is at the sole risk of the user relying on this information.



PROJECT NO.	20153942
DRAWN:	5/21/2015
DRAWN BY:	B. Myers
CHECKED BY:	M. Baird
FILE NAME:	

Northeast Area Well Locations

INACTIVE EXXON FACILITY #28077
 14258 JARRETTSVILLE PIKE
 PHOENIX, MARYLAND
 BALTIMORE COUNTY

FIGURE
1

G:\Projects\0507606-8077\Projects\Proposals\Fig1 - Prop. MW78C_FlueRemoval_11x17_051315.mxd

TABLE

Private Supply Well Analytical Data Table: 3627A Southside Avenue
 Inactive Exxon Facility #28077
 14258 Jarrettsville Pike
 Phoenix, MD

Map/Parcel/Lot	Address	Sample Date	POET Sample Point	MTBE (µg/L)	Benzene (µg/L)	Toluene (µg/L)	Ethyl-Benzene (µg/L)	Total Xylenes (µg/L)	Naphthalene (µg/L)	DIPE (µg/L)	ETBE (µg/L)	TAME (µg/L)	TBA (µg/L)
M36P122LNA	3627A Southside Ave	3/21/2006		0.30 J	ND(0.50)	ND(0.50)	ND(0.50)	ND(0.50)	ND(0.50)	ND(0.50)	ND(0.50)	ND(0.50)	ND(5.0)
M36P122LNA	3627A Southside Ave	4/19/2006		0.38 J	ND(0.50)	ND(0.50)	ND(0.50)	ND(0.50)	ND(0.50)	ND(0.50)	ND(0.50)	ND(0.50)	ND(5.0)
M36P122LNA	3627A Southside Ave	6/14/2006		ND(0.50)	ND(0.50)	ND(0.50)	ND(0.50)	ND(0.50)	ND(0.50)	ND(0.50)	ND(0.50)	ND(0.50)	ND(5.0)
M36P122LNA	3627A Southside Ave	8/16/2006		0.29 J	ND(0.50)	ND(0.50)	ND(0.50)	ND(0.50)	ND(0.50)	ND(0.50)	ND(0.50)	ND(0.50)	ND(5.0)
M36P122LNA	3627A Southside Ave	1/22/2007		0.33 J	ND(0.50)	ND(0.50)	ND(0.50)	ND(0.50)	ND(0.50)	ND(0.50)	ND(0.50)	ND(0.50)	ND(5.0)
M36P122LNA	3627A Southside Ave	4/9/2007		ND(0.50)	ND(0.50)	ND(0.50)	ND(0.50)	ND(0.50)	ND(0.50)	ND(0.50)	ND(0.50)	ND(0.50)	ND(5.0)
M36P122LNA	3627A Southside Ave	7/17/2007		0.26 J	ND(0.50)	ND(0.50)	ND(0.50)	ND(0.50)	ND(0.50)	ND(0.50)	ND(0.50)	ND(0.50)	ND(5.0)
M36P122LNA	3627A Southside Ave	10/24/2007		0.54	ND(0.50)	ND(0.50)	ND(0.50)	ND(0.50)	ND(0.50)	ND(0.50)	ND(0.50)	ND(0.50)	ND(5.0)
M36P122LNA	3627A Southside Ave	1/15/2008		0.76	ND(0.5)	ND(0.5)	ND(0.5)	ND(0.5)	ND(0.5)	ND(0.5)	ND(0.5)	ND(0.5)	ND(5)
M36P122LNA	3627A Southside Ave	4/3/2008		0.76	ND(0.50)	0.20 J	ND(0.50)	ND(0.50)	ND(0.50)	ND(0.50)	ND(0.50)	ND(0.50)	ND(5.0)
M36P122LNA	3627A Southside Ave	7/14/2008		0.48 J	ND(0.50)	0.12 J	ND(0.50)	ND(0.50)	ND(0.50)	ND(0.50)	ND(0.50)	ND(0.50)	ND(5.0)
M36P122LNA	3627A Southside Ave	10/8/2008		0.68	ND(0.50)	ND(0.50)	ND(0.50)	ND(0.50)	ND(0.50)	ND(0.50)	ND(0.50)	ND(0.50)	ND(5.0)
M36P122LNA	3627A Southside Ave	1/13/2009		0.92	ND(0.50)	ND(0.50)	ND(0.50)	ND(0.50)	ND(0.50)	ND(0.50)	ND(0.50)	ND(0.50)	ND(5.0)
M36P122LNA	3627A Southside Ave	4/2/2009		0.50	ND(0.50)	ND(0.50)	ND(0.50)	ND(0.50)	ND(0.50)	ND(0.50)	ND(0.50)	ND(0.50)	ND(5.0)
M36P122LNA	3627A Southside Ave	7/9/2009		0.64	ND(0.50)	ND(0.50)	ND(0.50)	ND(0.50)	ND(0.50)	ND(0.50)	ND(0.50)	ND(0.50)	ND(5.0)
M36P122LNA	3627A Southside Ave	10/8/2009		0.89	ND(0.50)	ND(0.50)	ND(0.50)	ND(0.50)	ND(0.50)	ND(0.50)	ND(0.50)	ND(0.50)	ND(5.0)
M36P122LNA	3627A Southside Ave	1/11/2010		ND(0.50)	ND(0.50)	ND(0.50)	ND(0.50)	ND(0.50)	ND(0.50)	ND(0.50)	ND(0.50)	ND(0.50)	ND(5.0)
M36P122LNA	3627A Southside Ave	4/12/2010		ND(0.5)	ND(0.5)	0.2 J	ND(0.5)	ND(0.5)	ND(0.5)	ND(0.5)	ND(0.5)	ND(0.5)	ND(5)
M36P122LNA	3627A Southside Ave	7/13/2010		0.50	ND(0.50)	2.6	ND(0.50)	ND(0.50)	ND(0.50)	ND(0.50)	ND(0.50)	ND(0.50)	ND(5.0)
M36P122LNA	3627A Southside Ave	10/21/2010		1.6	ND(0.50)	ND(0.50)	ND(0.50)	ND(0.50)	ND(0.50)	ND(0.50)	0.067 J	ND(0.50)	ND(5.0)
M36P122LNA	3627A Southside Ave	1/13/2011		1.9	ND(0.50)	ND(0.50)	ND(0.50)	ND(0.50)	ND(0.50)	ND(0.50)	0.10 J	ND(0.50)	ND(5.0)
M36P122LNA	3627A Southside Ave	4/11/2011		0.87	ND(0.50)	ND(0.50)	ND(0.50)	ND(0.50)	ND(0.50)	ND(0.50)	ND(0.50)	ND(0.50)	ND(5.0)
M36P122LNA	3627A Southside Ave	7/11/2011		1.3	ND(0.50)	ND(0.50)	ND(0.50)	ND(0.50)	ND(0.50)	ND(0.50)	ND(0.50)	ND(0.50)	ND(5.0)
M36P122LNA	3627A Southside Ave	10/17/2011		1.8	ND(0.50)	ND(0.50)	ND(0.50)	ND(0.50)	ND(0.50)	ND(0.50)	ND(0.50)	ND(0.50)	ND(5.0)
M36P122LNA	3627A Southside Ave	1/11/2012		1.6	ND(0.50)	ND(0.50)	ND(0.50)	ND(0.50)	ND(0.50)	ND(0.50)	ND(0.50)	ND(0.50)	ND(5.0)
M36P122LNA	3627A Southside Ave	4/11/2012		2.4	ND(0.50)	ND(0.50)	ND(0.50)	ND(0.50)	ND(0.50)	ND(0.50)	ND(0.50)	0.097 J	ND(5.0)
M36P122LNA	3627A Southside Ave	7/13/2012		5.4	ND(0.50)	0.13 J	ND(0.50)	ND(0.50)	ND(0.50)	ND(0.50)	0.12 J	0.30 J	ND(5.0)
M36P122LNA	3627A Southside Ave	9/11/2012	PIO	7.3	ND(0.50)	ND(0.50)	ND(0.50)	ND(0.50)	ND(0.50)	ND(0.50)	0.14 J	0.40 J	ND(5.0)
M36P122LNA	3627A Southside Ave	9/11/2012	PEO	0.20 J	ND(0.50)	ND(0.50)	ND(0.50)	ND(0.50)	ND(0.50)	ND(0.50)	ND(0.50)	ND(0.50)	ND(5.0)
M36P122LNA	3627A Southside Ave	10/2/2012	PIO	8.7	ND(0.50)	ND(0.50)	ND(0.50)	ND(0.50)	ND(0.50)	ND(0.50)	0.17 J	0.47 J	ND(5.0)
M36P122LNA	3627A Southside Ave	11/6/2012	PIO	7.3	0.074 J	ND(0.50)	ND(0.50)	ND(0.50)	ND(0.50)	ND(0.50)	0.16 J	0.55	ND(5.0)
M36P122LNA	3627A Southside Ave	11/6/2012	PEO	7.0	0.066 J	ND(0.50)	ND(0.50)	ND(0.50)	ND(0.50)	ND(0.50)	0.16 J	0.54	ND(5.0)
M36P122LNA	3627A Southside Ave	12/4/2012	PIO	9.4	0.084 J	ND(0.50)	ND(0.50)	ND(0.50)	ND(0.50)	ND(0.50)	0.19 J	0.61	ND(5.0)
M36P122LNA	3627A Southside Ave	12/4/2012	PEO	0.29 J	ND(0.50)	ND(0.50)	ND(0.50)	ND(0.50)	ND(0.50)	ND(0.50)	ND(0.50)	ND(0.50)	ND(5.0)
M36P122LNA	3627A Southside Ave	1/8/2013	PIO	7.6	ND(0.50)	ND(0.50)	ND(0.50)	ND(0.50)	ND(0.50)	ND(0.50)	0.12 J	0.49 J	ND(5.0)
M36P122LNA	3627A Southside Ave	1/8/2013	PEO	0.31 J	ND(0.50)	ND(0.50)	ND(0.50)	ND(0.50)	ND(0.50)	ND(0.50)	ND(0.50)	ND(0.50)	ND(5.0)

Private Supply Well Analytical Data Table: 3627A Southside Avenue
Inactive Exxon Facility #28077
14258 Jarrettsville Pike
Phoenix, MD

Map/Parcel/Lot	Address	Sample Date	POET Sample Point	MTBE (µg/L)	Benzene (µg/L)	Toluene (µg/L)	Ethyl-Benzene (µg/L)	Total Xylenes (µg/L)	Naphthalene (µg/L)	DIPE (µg/L)	ETBE (µg/L)	TAME (µg/L)	TBA (µg/L)
M36P122LNA	3627A Southside Ave	2/6/2013	PIO	0.37 J	ND(0.50)	ND(0.50)	ND(0.50)	ND(0.50)	ND(0.50)	ND(0.50)	ND(0.50)	ND(0.50)	ND(5.0)
M36P122LNA	3627A Southside Ave	2/6/2013	PEO	0.63	ND(0.50)	ND(0.50)	ND(0.50)	ND(0.50)	ND(0.50)	ND(0.50)	ND(0.50)	ND(0.50)	ND(5.0)
M36P122LNA	3627A Southside Ave	3/5/2013	PIO	10.3	0.10 J	ND(0.50)	ND(0.50)	ND(0.50)	ND(0.50)	ND(0.50)	0.19 J	0.81	ND(5.0)
M36P122LNA	3627A Southside Ave	3/5/2013	PEO	1.1	ND(0.50)	ND(0.50)	ND(0.50)	ND(0.50)	ND(0.50)	ND(0.50)	ND(0.50)	ND(0.50)	ND(5.0)
M36P122LNA	3627A Southside Ave	4/2/2013	PIO	10.3	0.12 J	ND(0.50)	ND(0.50)	ND(0.50)	ND(0.50)	ND(0.50)	0.18 J	0.77	ND(5.0)
M36P122LNA	3627A Southside Ave	4/2/2013	PEO	1.1	ND(0.50)	ND(0.50)	ND(0.50)	ND(0.50)	ND(0.50)	ND(0.50)	ND(0.50)	ND(0.50)	ND(5.0)
M36P122LNA	3627A Southside Ave	5/7/2013	PIO	8.4	0.051 J	0.12 J	ND(0.50)	ND(0.50)	ND(0.50)	ND(0.50)	0.14 J	0.70	ND(5.0)
M36P122LNA	3627A Southside Ave	5/7/2013	PEO	ND(0.50)	ND(0.50)	ND(0.50)	ND(0.50)	ND(0.50)	ND(0.50)	ND(0.50)	ND(0.50)	ND(0.50)	ND(5.0)
M36P122LNA	3627A Southside Ave	6/4/2013	PIO	9.5	ND(0.50)	ND(0.50)	ND(0.50)	ND(0.50)	ND(0.50)	ND(0.50)	0.15 J	0.55	ND(5.0)
M36P122LNA	3627A Southside Ave	6/4/2013	PEO	ND(0.50)	ND(0.50)	ND(0.50)	ND(0.50)	ND(0.50)	ND(0.50)	ND(0.50)	ND(0.50)	ND(0.50)	ND(5.0)
M36P122LNA	3627A Southside Ave	7/2/2013	PIO	12.4	0.083 J	ND(0.50)	ND(0.50)	ND(0.50)	ND(0.50)	ND(0.50)	0.19 J	0.85	ND(5.0)
M36P122LNA	3627A Southside Ave	7/2/2013	PEO	ND(0.50)	ND(0.50)	ND(0.50)	ND(0.50)	ND(0.50)	ND(0.50)	ND(0.50)	ND(0.50)	ND(0.50)	ND(5.0)
M36P122LNA	3627A Southside Ave	8/6/2013	PIO	14.8	ND(0.50)	1.0	ND(0.50)	ND(0.50)	ND(0.50)	ND(0.50)	0.20 J	0.88	ND(5.0)
M36P122LNA	3627A Southside Ave	8/6/2013	PEO	ND(0.50)	ND(0.50)	1.1	ND(0.50)	ND(0.50)	ND(0.50)	ND(0.50)	ND(0.50)	ND(0.50)	ND(5.0)
M36P122LNA	3627A Southside Ave	8/14/2013	PIO	13.8	0.18 J	0.40 J	ND(0.50)	ND(0.50)	ND(0.50)	0.097 J	0.25 J	1.0	ND(5.0)
M36P122LNA	3627A Southside Ave	8/14/2013	PEO	ND(0.50)	ND(0.50)	0.19 J	ND(0.50)	ND(0.50)	ND(0.50)	ND(0.50)	ND(0.50)	ND(0.50)	ND(5.0)
M36P122LNA	3627A Southside Ave	9/10/2013	PIO	16.5	0.38 J	0.21 J	0.047 J	0.087 J	ND(0.50)	0.097 J	0.34 J	1.4	ND(5.0)
M36P122LNA	3627A Southside Ave	9/10/2013	PEO	ND(0.50)	ND(0.50)	0.13 J	ND(0.50)	ND(0.50)	ND(0.50)	ND(0.50)	ND(0.50)	ND(0.50)	ND(5.0)
M36P122LNA	3627A Southside Ave	10/8/2013	PIO	13.2	ND(0.50)	0.13 J	ND(0.50)	ND(0.50)	ND(0.50)	0.070 J	0.30 J	1.0	ND(5.0)
M36P122LNA	3627A Southside Ave	10/8/2013	PEO	ND(0.50)	ND(0.50)	ND(0.50)	ND(0.50)	ND(0.50)	ND(0.50)	ND(0.50)	ND(0.50)	ND(0.50)	ND(5.0)
M36P122LNA	3627A Southside Ave	10/22/2013	PE	ND(0.50)	ND(0.50)	ND(0.50)	ND(0.50)	ND(0.50)	ND(0.50)	ND(0.50)	ND(0.50)	ND(0.50)	ND(5.0)
M36P122LNA	3627A Southside Ave	10/22/2013	PI	8.9	0.19 J	0.074 J	ND(0.50)	ND(0.50)	ND(0.50)	0.056 J	0.21 J	0.81	ND(5.0)
M36P122LNA	3627A Southside Ave	10/22/2013	PM	ND(0.50)	ND(0.50)	ND(0.50)	ND(0.50)	ND(0.50)	ND(0.50)	ND(0.50)	ND(0.50)	ND(0.50)	ND(5.0)
M36P122LNA	3627A Southside Ave	11/4/2013	PE	ND(0.50)	ND(0.50)	ND(0.50)	ND(0.50)	ND(0.50)	ND(0.50)	ND(0.50)	ND(0.50)	ND(0.50)	ND(5.0)
M36P122LNA	3627A Southside Ave	11/4/2013	PI	14.9	0.29 J	ND(0.50)	ND(0.50)	ND(0.50)	ND(0.50)	0.072 J	0.33 J	1.3	ND(5.0)
M36P122LNA	3627A Southside Ave	11/4/2013	PM	ND(0.50)	ND(0.50)	ND(0.50)	ND(0.50)	ND(0.50)	ND(0.50)	ND(0.50)	ND(0.50)	ND(0.50)	ND(5.0)
M36P122LNA	3627A Southside Ave	12/3/2013	PE	ND(0.50)	ND(0.50)	ND(0.50)	ND(0.50)	ND(0.50)	ND(0.50)	ND(0.50)	ND(0.50)	ND(0.50)	ND(5.0)
M36P122LNA	3627A Southside Ave	12/3/2013	PI	16.5	0.28 J	ND(0.50)	ND(0.50)	ND(0.50)	ND(0.50)	0.081 J	0.39 J	1.4	ND(5.0)
M36P122LNA	3627A Southside Ave	12/3/2013	PM	ND(0.50)	ND(0.50)	ND(0.50)	ND(0.50)	ND(0.50)	ND(0.50)	ND(0.50)	ND(0.50)	ND(0.50)	ND(5.0)
M36P122LNA	3627A Southside Ave	12/19/2013	PE	ND(0.50)	ND(0.50)	ND(0.50)	ND(0.50)	ND(0.50)	ND(0.50)	ND(0.50)	ND(0.50)	ND(0.50)	ND(5.0)
M36P122LNA	3627A Southside Ave	12/19/2013	PI	12.7	0.19 J	ND(0.50)	ND(0.50)	ND(0.50)	ND(0.50)	0.065 J	0.25 J	1.0	ND(5.0)
M36P122LNA	3627A Southside Ave	12/19/2013	PM	ND(0.50)	ND(0.50)	ND(0.50)	ND(0.50)	ND(0.50)	ND(0.50)	ND(0.50)	ND(0.50)	ND(0.50)	ND(5.0)
M36P122LNA	3627A Southside Ave	1/7/2014	PE	ND(0.50)	ND(0.50)	ND(0.50)	ND(0.50)	ND(0.50)	ND(0.50)	ND(0.50)	ND(0.50)	ND(0.50)	ND(5.0)
M36P122LNA	3627A Southside Ave	1/7/2014	PI	17.1	0.18 J	ND(0.50)	ND(0.50)	ND(0.50)	ND(0.50)	0.074 J	0.31 J	1.2	ND(5.0)
M36P122LNA	3627A Southside Ave	1/7/2014	PM	ND(0.50)	ND(0.50)	ND(0.50)	ND(0.50)	ND(0.50)	ND(0.50)	ND(0.50)	ND(0.50)	ND(0.50)	ND(5.0)

Private Supply Well Analytical Data Table: 3627A Southside Avenue
 Inactive Exxon Facility #28077
 14258 Jarrettsville Pike
 Phoenix, MD

Map/Parcel/Lot	Address	Sample Date	POET Sample Point	MTBE (µg/L)	Benzene (µg/L)	Toluene (µg/L)	Ethyl-Benzene (µg/L)	Total Xylenes (µg/L)	Naphthalene (µg/L)	DIPE (µg/L)	ETBE (µg/L)	TAME (µg/L)	TBA (µg/L)
M36P122LNA	3627A Southside Ave	2/4/2014	PE	ND(0.50)	ND(0.50)	ND(0.50)	ND(0.50)	ND(0.50)	ND(0.50)	ND(0.50)	ND(0.50)	ND(0.50)	ND(5.0)
M36P122LNA	3627A Southside Ave	2/4/2014	PI	16.1	0.20 J	ND(0.50)	ND(0.50)	ND(0.50)	ND(0.50)	0.091 J	0.31 J	1.3	ND(5.0)
M36P122LNA	3627A Southside Ave	2/4/2014	PM	ND(0.50)	ND(0.50)	ND(0.50)	ND(0.50)	ND(0.50)	ND(0.50)	ND(0.50)	ND(0.50)	ND(0.50)	ND(5.0)
M36P122LNA	3627A Southside Ave	3/4/2014	PE	ND(0.50)	ND(0.50)	ND(0.50)	ND(0.50)	ND(0.50)	ND(0.50)	ND(0.50)	ND(0.50)	ND(0.50)	ND(5.0)
M36P122LNA	3627A Southside Ave	3/4/2014	PI	14.8	0.20 J	ND(0.50)	ND(0.50)	ND(0.50)	ND(0.50)	0.072 J	0.27 J	1.0	ND(5.0)
M36P122LNA	3627A Southside Ave	3/4/2014	PM	ND(0.50)	ND(0.50)	ND(0.50)	ND(0.50)	ND(0.50)	ND(0.50)	ND(0.50)	ND(0.50)	ND(0.50)	ND(5.0)
M36P122LNA	3627A Southside Ave	4/8/2014	PE	ND(0.50)	ND(0.50)	ND(0.50)	ND(0.50)	ND(0.50)	ND(0.50)	ND(0.50)	ND(0.50)	ND(0.50)	ND(5.0)
M36P122LNA	3627A Southside Ave	4/8/2014	PI	0.15 J	ND(0.50)	ND(0.50)	ND(0.50)	ND(0.50)	ND(0.50)	ND(0.50)	ND(0.50)	ND(0.50)	ND(5.0)
M36P122LNA	3627A Southside Ave	4/8/2014	PM	ND(0.50)	ND(0.50)	ND(0.50)	ND(0.50)	ND(0.50)	ND(0.50)	ND(0.50)	ND(0.50)	ND(0.50)	ND(5.0)
M36P122LNA	3627A Southside Ave	4/24/2014	PE	ND(0.50)	ND(0.50)	ND(0.50)	ND(0.50)	ND(0.50)	ND(0.50)	ND(0.50)	ND(0.50)	ND(0.50)	ND(5.0)
M36P122LNA	3627A Southside Ave	4/24/2014	PI	0.11 J	ND(0.50)	ND(0.50)	ND(0.50)	ND(0.50)	ND(0.50)	ND(0.50)	ND(0.50)	ND(0.50)	ND(5.0)
M36P122LNA	3627A Southside Ave	4/24/2014	PM	ND(0.50)	ND(0.50)	ND(0.50)	ND(0.50)	ND(0.50)	ND(0.50)	ND(0.50)	ND(0.50)	ND(0.50)	ND(5.0)
M36P122LNA	3627A Southside Ave	5/6/2014	PE	ND(0.50)	ND(0.50)	ND(0.50)	ND(0.50)	ND(0.50)	ND(0.50)	ND(0.50)	ND(0.50)	ND(0.50)	ND(5.0)
M36P122LNA	3627A Southside Ave	5/6/2014	PI	ND(0.50)	ND(0.50)	ND(0.50)	ND(0.50)	ND(0.50)	ND(0.50)	ND(0.50)	ND(0.50)	ND(0.50)	ND(5.0)
M36P122LNA	3627A Southside Ave	5/6/2014	PM	ND(0.50)	ND(0.50)	ND(0.50)	ND(0.50)	ND(0.50)	ND(0.50)	ND(0.50)	ND(0.50)	ND(0.50)	ND(5.0)
M36P122LNA	3627A Southside Ave	6/3/2014	PE	ND(0.50)	ND(0.50)	ND(0.50)	ND(0.50)	ND(0.50)	ND(0.50)	ND(0.50)	ND(0.50)	ND(0.50)	ND(5.0)
M36P122LNA	3627A Southside Ave	6/3/2014	PI	ND(0.50)	ND(0.50)	ND(0.50)	ND(0.50)	ND(0.50)	ND(0.50)	ND(0.50)	ND(0.50)	ND(0.50)	ND(5.0)
M36P122LNA	3627A Southside Ave	6/3/2014	PM	ND(0.50)	ND(0.50)	ND(0.50)	ND(0.50)	ND(0.50)	ND(0.50)	ND(0.50)	ND(0.50)	ND(0.50)	ND(5.0)
M36P122LNA	3627A Southside Ave	7/8/2014	PE	ND(0.50)	ND(0.50)	ND(0.50)	ND(0.50)	ND(0.50)	ND(0.50)	ND(0.50)	ND(0.50)	ND(0.50)	ND(5.0)
M36P122LNA	3627A Southside Ave	7/8/2014	PI	1.1	ND(0.50)	ND(0.50)	ND(0.50)	ND(0.50)	ND(0.50)	ND(0.50)	ND(0.50)	ND(0.50)	ND(5.0)
M36P122LNA	3627A Southside Ave	7/8/2014	PM	ND(0.50)	ND(0.50)	ND(0.50)	ND(0.50)	ND(0.50)	ND(0.50)	ND(0.50)	ND(0.50)	ND(0.50)	ND(5.0)
M36P122LNA	3627A Southside Ave	8/5/2014	PE	ND(0.50)	ND(0.50)	ND(0.50)	ND(0.50)	ND(0.50)	ND(0.50)	ND(0.50)	ND(0.50)	ND(0.50)	ND(5.0)
M36P122LNA	3627A Southside Ave	8/5/2014	PI	7.6	ND(0.50)	ND(0.50)	ND(0.50)	ND(0.50)	ND(0.50)	ND(0.50)	0.11 J	0.48 J	ND(5.0)
M36P122LNA	3627A Southside Ave	8/5/2014	PM	ND(0.50)	ND(0.50)	ND(0.50)	ND(0.50)	ND(0.50)	ND(0.50)	ND(0.50)	ND(0.50)	ND(0.50)	ND(5.0)
M36P122LNA	3627A Southside Ave	9/9/2014	PE	ND(0.50)	ND(0.50)	ND(0.50)	ND(0.50)	ND(0.50)	ND(0.50)	ND(0.50)	ND(0.50)	ND(0.50)	ND(5.0)
M36P122LNA	3627A Southside Ave	9/9/2014	PI	23.3	0.20 J	ND(0.50)	ND(0.50)	ND(0.50)	ND(0.50)	0.12 J	0.38 J	1.7	ND(5.0)
M36P122LNA	3627A Southside Ave	9/9/2014	PM	ND(0.50)	ND(0.50)	ND(0.50)	ND(0.50)	ND(0.50)	ND(0.50)	ND(0.50)	ND(0.50)	ND(0.50)	ND(5.0)
M36P122LNA	3627A Southside Ave	10/7/2014	PE	ND(0.50)	ND(0.50)	ND(0.50)	ND(0.50)	ND(0.50)	ND(0.50)	ND(0.50)	ND(0.50)	ND(0.50)	ND(5.0)
M36P122LNA	3627A Southside Ave	10/7/2014	PI	25.6	0.25 J	ND(0.50)	ND(0.50)	ND(0.50)	ND(0.50)	0.14 J	0.42 J	2.0	2.1
M36P122LNA	3627A Southside Ave	10/7/2014	PM	ND(0.50)	ND(0.50)	ND(0.50)	ND(0.50)	ND(0.50)	ND(0.50)	ND(0.50)	ND(0.50)	ND(0.50)	ND(5.0)
M36P122LNA	3627A Southside Ave	11/4/2014	PE	ND(0.50)	ND(0.50)	ND(0.50)	ND(0.50)	ND(0.50)	ND(0.50)	ND(0.50)	ND(0.50)	ND(0.50)	ND(5.0)
M36P122LNA	3627A Southside Ave	11/4/2014	PI	26.4	0.36 J	ND(0.50)	ND(0.50)	ND(0.50)	ND(0.50)	0.12 J	0.45 J	2.0	ND(5.0)
M36P122LNA	3627A Southside Ave	11/4/2014	PM	ND(0.50)	ND(0.50)	ND(0.50)	ND(0.50)	ND(0.50)	ND(0.50)	ND(0.50)	ND(0.50)	ND(0.50)	ND(5.0)
M36P122LNA	3627A Southside Ave	12/2/2014	PE	ND(0.50)	ND(0.50)	ND(0.50)	ND(0.50)	ND(0.50)	ND(0.50)	ND(0.50)	ND(0.50)	ND(0.50)	ND(5.0)
M36P122LNA	3627A Southside Ave	12/2/2014	PI	26.5	0.21 J	ND(0.50)	ND(0.50)	ND(0.50)	ND(0.50)	0.11 J	0.45 J	2.0	ND(5.0)
M36P122LNA	3627A Southside Ave	12/2/2014	PM	ND(0.50)	ND(0.50)	ND(0.50)	ND(0.50)	ND(0.50)	ND(0.50)	ND(0.50)	ND(0.50)	ND(0.50)	ND(5.0)

Private Supply Well Analytical Data Table: 3627A Southside Avenue
 Inactive Exxon Facility #28077
 14258 Jarrettsville Pike
 Phoenix, MD

Map/Parcel/Lot	Address	Sample Date	POET Sample Point	MTBE (µg/L)	Benzene (µg/L)	Toluene (µg/L)	Ethyl-Benzene (µg/L)	Total Xylenes (µg/L)	Naphthalene (µg/L)	DIPE (µg/L)	ETBE (µg/L)	TAME (µg/L)	TBA (µg/L)
M36P122LNA	3627A Southside Ave	1/8/2015	PE	ND(0.50)	ND(0.50)	ND(0.50)	ND(0.50)	ND(0.50)	ND(0.50)	ND(0.50)	ND(0.50)	ND(0.50)	ND(25)
M36P122LNA	3627A Southside Ave	1/8/2015	PI	28	0.3 J	ND(0.50)	ND(0.50)	ND(0.50)	ND(0.50)	0.1 J	0.4 J	1.6	ND(25)
M36P122LNA	3627A Southside Ave	1/8/2015	PM	ND(0.50)	ND(0.50)	ND(0.50)	ND(0.50)	ND(0.50)	ND(0.50)	ND(0.50)	ND(0.50)	ND(0.50)	ND(25)
M36P122LNA	3627A Southside Ave	2/3/2015	PE	ND(0.5)	ND(0.5)	ND(0.5)	ND(0.5)	ND(0.5)	ND(0.5)	ND(0.5)	ND(0.5)	ND(0.5)	ND(25)
M36P122LNA	3627A Southside Ave	2/3/2015	PI	25	ND(0.5)	ND(0.5)	ND(0.5)	ND(0.5)	ND(0.5)	0.1 J	0.5 J	1.8	ND(25)
M36P122LNA	3627A Southside Ave	2/3/2015	PM	ND(0.5)	ND(0.5)	ND(0.5)	ND(0.5)	ND(0.5)	ND(0.5)	ND(0.5)	ND(0.5)	ND(0.5)	ND(25)
M36P122LNA	3627A Southside Ave	3/3/2015	PE	ND(0.5)	ND(0.5)	ND(0.5)	ND(0.5)	ND(0.5)	ND(0.5)	ND(0.5)	ND(0.5)	ND(0.5)	ND(25)
M36P122LNA	3627A Southside Ave	3/3/2015	PI	26	ND(0.5)	ND(0.5)	ND(0.5)	ND(0.5)	ND(0.5)	ND(0.5)	0.4 J	1.7	ND(25)
M36P122LNA	3627A Southside Ave	3/3/2015	PM	ND(0.5)	ND(0.5)	ND(0.5)	ND(0.5)	ND(0.5)	ND(0.5)	ND(0.5)	ND(0.5)	ND(0.5)	ND(25)
M36P122LNA	3627A Southside Ave	4/7/2015	PE	ND(0.5)	ND(0.5)	ND(0.5)	ND(0.5)	ND(0.5)	ND(0.5)	ND(0.5)	ND(0.5)	ND(0.5)	ND(25)
M36P122LNA	3627A Southside Ave	4/7/2015	PI	15	ND(0.5)	ND(0.5)	ND(0.5)	ND(0.5)	ND(0.5)	ND(0.5)	0.2 J	1.1	ND(25)
M36P122LNA	3627A Southside Ave	4/7/2015	PM	ND(0.5)	ND(0.5)	ND(0.5)	ND(0.5)	ND(0.5)	ND(0.5)	ND(0.5)	ND(0.5)	ND(0.5)	ND(25)
M36P122LNA	3627A Southside Ave	5/5/2015	PE	ND(0.5)	ND(0.5)	1.1	0.2 J	0.6	ND(0.5)	ND(0.5)	ND(0.5)	ND(0.5)	ND(25)
M36P122LNA	3627A Southside Ave	5/5/2015	PI	22	0.1 J	0.2 J	ND(0.5)	ND(0.5)	ND(0.5)	ND(0.5)	0.3 J	1.2	ND(25)
M36P122LNA	3627A Southside Ave	5/5/2015	PM	ND(0.5)	ND(0.5)	1.1	0.1 J	0.7	ND(0.5)	ND(0.5)	ND(0.5)	ND(0.5)	ND(25)
M36P122LNA	3627A Southside Ave	5/12/2015	PE	ND(0.5)	ND(0.5)	ND(0.5)	ND(0.5)	ND(0.5)	ND(0.5)	ND(0.5)	ND(0.5)	ND(0.5)	ND(25)
M36P122LNA	3627A Southside Ave	5/12/2015	PI	21	ND(0.5)	ND(0.5)	ND(0.5)	ND(0.5)	ND(0.5)	ND(0.5)	0.3 J	0.9	ND(25)
M36P122LNA	3627A Southside Ave	5/12/2015	PM	ND(0.5)	ND(0.5)	ND(0.5)	ND(0.5)	ND(0.5)	ND(0.5)	ND(0.5)	ND(0.5)	ND(0.5)	ND(25)
M36P122LNA	3627A Southside Ave	6/2/2015	PE	ND(0.5)	ND(0.5)	0.2 J	ND(0.5)	ND(0.5)	ND(0.5)	ND(0.5)	ND(0.5)	ND(0.5)	ND(25)
M36P122LNA	3627A Southside Ave	6/2/2015	PI	18	ND(0.5)	0.2 J	ND(0.5)	ND(0.5)	ND(0.5)	ND(0.5)	0.4 J	0.6	ND(25)
M36P122LNA	3627A Southside Ave	6/2/2015	PM	ND(0.5)	ND(0.5)	0.2 J	ND(0.5)	ND(0.5)	ND(0.5)	ND(0.5)	ND(0.5)	ND(0.5)	ND(25)
M36P122LNA	3627A Southside Ave	7/7/2015	PE	ND(0.5)	ND(0.5)	0.2 J	ND(0.5)	ND(0.5)	ND(0.5)	ND(0.5)	ND(0.5)	ND(0.5)	ND(25)
M36P122LNA	3627A Southside Ave	7/7/2015	PI	29	0.3 J	ND(0.5)	ND(0.5)	ND(0.5)	ND(0.5)	ND(0.5)	0.5 J	1.7	ND(25)
M36P122LNA	3627A Southside Ave	7/7/2015	PM	ND(0.5)	ND(0.5)	0.2 J	ND(0.5)	ND(0.5)	ND(0.5)	ND(0.5)	ND(0.5)	ND(0.5)	ND(25)
M36P122LNA	3627A Southside Ave	8/11/2015	PE	ND(0.5)	ND(0.5)	0.1 J	ND(0.5)	ND(0.5)	ND(0.5)	ND(0.5)	ND(0.5)	ND(0.5)	ND(25)
M36P122LNA	3627A Southside Ave	8/11/2015	PI	19	0.2 J	ND(0.5)	ND(0.5)	ND(0.5)	ND(0.5)	ND(0.5)	0.3 J	1.4	ND(25)
M36P122LNA	3627A Southside Ave	8/11/2015	PM	ND(0.5)	ND(0.5)	ND(0.5)	ND(0.5)	ND(0.5)	ND(0.5)	ND(0.5)	ND(0.5)	ND(0.5)	ND(25)
M36P122LNA	3627A Southside Ave	8/20/2015	PE	ND(0.5)	ND(0.5)	0.1 J	ND(0.5)	ND(0.5)	ND(0.5)	ND(0.5)	ND(0.5)	ND(0.5)	ND(25)
M36P122LNA	3627A Southside Ave	8/20/2015	PI	20	0.2 J	ND(0.5)	ND(0.5)	ND(0.5)	ND(0.5)	ND(0.5)	0.3 J	1.2	ND(25)
M36P122LNA	3627A Southside Ave	8/20/2015	PM	ND(0.5)	ND(0.5)	ND(0.5)	ND(0.5)	ND(0.5)	ND(0.5)	ND(0.5)	ND(0.5)	ND(0.5)	ND(25)
M36P122LNA	3627A Southside Ave	9/15/2015	PE	ND(0.5)	ND(0.5)	ND(0.5)	ND(0.5)	ND(0.5)	ND(0.5)	ND(0.5)	ND(0.5)	ND(0.5)	ND(25)
M36P122LNA	3627A Southside Ave	9/15/2015	PI	32	0.2 J	ND(0.5)	ND(0.5)	ND(0.5)	ND(0.5)	0.1 J	ND(0.5)	1.7	ND(25)
M36P122LNA	3627A Southside Ave	9/15/2015	PM	ND(0.5)	ND(0.5)	ND(0.5)	ND(0.5)	ND(0.5)	ND(0.5)	ND(0.5)	ND(0.5)	ND(0.5)	ND(25)
M36P122LNA	3627A Southside Ave	10/6/2015	PE	ND(0.5)	ND(0.5)	4.7	ND(0.5)	ND(0.5)	ND(0.5)	ND(0.5)	ND(0.5)	ND(0.5)	ND(0.5)
M36P122LNA	3627A Southside Ave	10/6/2015	PI	36	0.3 J	6.2	ND(0.5)	ND(0.5)	ND(0.5)	0.1 J	0.5	2.8	ND(0.5)
M36P122LNA	3627A Southside Ave	10/6/2015	PM	ND(0.5)	ND(0.5)	4.2	ND(0.5)	ND(0.5)	ND(0.5)	ND(0.5)	ND(0.5)	ND(0.5)	ND(25)
M36P122LNA	3627A Southside Ave	11/3/2015	PE	ND(0.5)	ND(0.5)	ND(0.5)	ND(0.5)	ND(0.5)	ND(0.5)	ND(0.5)	ND(0.5)	ND(0.5)	ND(25)

Private Supply Well Analytical Data Table: 3627A Southside Avenue
 Inactive Exxon Facility #28077
 14258 Jarrettsville Pike
 Phoenix, MD

Map/Parcel/Lot	Address	Sample Date	POET Sample Point	MTBE (µg/L)	Benzene (µg/L)	Toluene (µg/L)	Ethyl-Benzene (µg/L)	Total Xylenes (µg/L)	Naphthalene (µg/L)	DIPE (µg/L)	ETBE (µg/L)	TAME (µg/L)	TBA (µg/L)
M36P122LNA	3627A Southside Ave	11/3/2015	PI	32	0.2 J	ND(0.5)	ND(0.5)	ND(0.5)	ND(0.5)	0.1 J	0.5 J	2.6	ND(25)
M36P122LNA	3627A Southside Ave	11/3/2015	PM	ND(0.5)	ND(0.5)	ND(0.5)	ND(0.5)	ND(0.5)	ND(0.5)	ND(0.5)	ND(0.5)	ND(0.5)	ND(25)
M36P122LNA	3627A Southside Ave	12/8/2015	PE	ND(0.5)	ND(0.5)	ND(0.5)	ND(0.5)	ND(0.5)	ND(0.5)	ND(0.5)	ND(0.5)	ND(0.5)	ND(25)
M36P122LNA	3627A Southside Ave	12/8/2015	PI	33	0.2 J	ND(0.5)	ND(0.5)	ND(0.5)	ND(0.5)	0.1 J	0.5 J	2.4	ND(25)
M36P122LNA	3627A Southside Ave	12/8/2015	PM	ND(0.5)	ND(0.5)	ND(0.5)	ND(0.5)	ND(0.5)	ND(0.5)	ND(0.5)	ND(0.5)	ND(0.5)	ND(25)
M36P122LNA	3627A Southside Ave	1/5/2016	PE	ND(0.5)	ND(0.5)	ND(0.5)	ND(0.5)	ND(0.5)	ND(0.5)	ND(0.5)	ND(0.5)	ND(0.5)	ND(25)
M36P122LNA	3627A Southside Ave	1/5/2016	PI	31	0.1 J	ND(0.5)	ND(0.5)	ND(0.5)	ND(0.5)	ND(0.5)	0.5 J	2.0	ND(25)
M36P122LNA	3627A Southside Ave	1/5/2016	PM	ND(0.5)	ND(0.5)	ND(0.5)	ND(0.5)	ND(0.5)	ND(0.5)	ND(0.5)	ND(0.5)	ND(0.5)	ND(25)
M36P122LNA	3627A Southside Ave	2/2/2016	PE	ND(0.5)	ND(0.5)	ND(0.5)	ND(0.5)	ND(0.5)	ND(0.5)	ND(0.5)	ND(0.5)	ND(0.5)	ND(25)
M36P122LNA	3627A Southside Ave	2/2/2016	PI	34	0.2 J	ND(0.5)	ND(0.5)	ND(0.5)	ND(0.5)	0.1 J	0.5 J	2.0	ND(25)
M36P122LNA	3627A Southside Ave	2/2/2016	PM	ND(0.5)	ND(0.5)	0.1 J	ND(0.5)	ND(0.5)	ND(0.5)	ND(0.5)	ND(0.5)	ND(0.5)	ND(25)
M36P122LNA	3627A Southside Ave	3/8/2016	PE	ND(0.5)	ND(0.5)	0.1 J	ND(0.5)	ND(0.5)	ND(0.5)	ND(0.5)	ND(0.5)	ND(0.5)	ND(25)
M36P122LNA	3627A Southside Ave	3/8/2016	PI	0.2 J	ND(0.5)	0.1 J	ND(0.5)	ND(0.5)	ND(0.5)	ND(0.5)	ND(0.5)	ND(0.5)	ND(25)
M36P122LNA	3627A Southside Ave	3/8/2016	PM	ND(0.5)	ND(0.5)	0.1 J	ND(0.5)	ND(0.5)	ND(0.5)	ND(0.5)	ND(0.5)	ND(0.5)	ND(25)
M36P122LNA	3627A Southside Ave	4/5/2016	PE	ND(0.5)	ND(0.5)	ND(0.5)	ND(0.5)	ND(0.5)	ND(0.5)	ND(0.5)	ND(0.5)	ND(0.5)	ND(25)
M36P122LNA	3627A Southside Ave	4/5/2016	PI	6.7	ND(0.5)	ND(0.5)	ND(0.5)	ND(0.5)	ND(0.5)	ND(0.5)	ND(0.5)	0.5	ND(25)
M36P122LNA	3627A Southside Ave	4/5/2016	PM	ND(0.5)	ND(0.5)	ND(0.5)	ND(0.5)	ND(0.5)	ND(0.5)	ND(0.5)	ND(0.5)	ND(0.5)	ND(25)
M36P122LNA	3627A Southside Ave	5/3/2016	PE	ND(0.5)	ND(0.5)	0.1 J	ND(0.5)	ND(0.5)	ND(0.5)	ND(0.5)	ND(0.5)	ND(0.5)	ND(25)
M36P122LNA	3627A Southside Ave	5/3/2016	PI	20	ND(0.5)	0.1 J	ND(0.5)	ND(0.5)	ND(0.5)	ND(0.5)	0.2 J	1.1	ND(25)
M36P122LNA	3627A Southside Ave	5/3/2016	PM	ND(0.5)	ND(0.5)	0.1 J	ND(0.5)	ND(0.5)	ND(0.5)	ND(0.5)	ND(0.5)	ND(0.5)	ND(25)
M36P122LNA	3627A Southside Ave	6/7/2016	PE	ND(0.5)	ND(0.5)	0.1 J	ND(0.5)	ND(0.5)	ND(0.5)	ND(0.5)	ND(0.5)	ND(0.5)	ND(25)
M36P122LNA	3627A Southside Ave	6/7/2016	PI	23	ND(0.5)	ND(0.5)	ND(0.5)	ND(0.5)	ND(0.5)	ND(0.5)	0.4 J	1.0	ND(25)
M36P122LNA	3627A Southside Ave	6/7/2016	PM	ND(0.5)	ND(0.5)	ND(0.5)	ND(0.5)	ND(0.5)	ND(0.5)	ND(0.5)	ND(0.5)	ND(0.5)	ND(25)
M36P122LNA	3627A Southside Ave	7/12/2016	PE	ND(0.5)	ND(0.5)	ND(0.5)	ND(0.5)	ND(0.5)	ND(0.5)	ND(0.5)	ND(0.5)	ND(0.5)	ND(25)
M36P122LNA	3627A Southside Ave	7/12/2016	PI	26	0.3 J	0.1 J	ND(0.5)	ND(0.5)	ND(0.5)	0.2 J	0.5 J	1.2	ND(25)
M36P122LNA	3627A Southside Ave	7/12/2016	PM	ND(0.5)	ND(0.5)	ND(0.5)	ND(0.5)	ND(0.5)	ND(0.5)	ND(0.5)	ND(0.5)	ND(0.5)	ND(25)
M36P122LNA	3627A Southside Ave	8/2/2016	PE	ND(0.5)	ND(0.5)	0.1 J	ND(0.5)	ND(0.5)	ND(0.5)	ND(0.5)	ND(0.5)	ND(0.5)	ND(25)
M36P122LNA	3627A Southside Ave	8/2/2016	PI	35	0.3 J	0.2 J	ND(0.5)	ND(0.5)	ND(0.5)	0.2 J	0.6	1.5	ND(25)
M36P122LNA	3627A Southside Ave	8/2/2016	PM	ND(0.5)	ND(0.5)	0.2 J	ND(0.5)	ND(0.5)	ND(0.5)	ND(0.5)	ND(0.5)	ND(0.5)	ND(25)
M36P122LNA	3627A Southside Ave	8/29/2016	PE	ND(0.5)	ND(0.5)	ND(0.5)	ND(0.5)	ND(0.5)	ND(0.5)	ND(0.5)	ND(0.5)	ND(0.5)	ND(25)
M36P122LNA	3627A Southside Ave	8/29/2016	PI	27	0.2 J	ND(0.5)	ND(0.5)	ND(0.5)	ND(0.5)	0.1 J	0.4 J	1.1	ND(25)
M36P122LNA	3627A Southside Ave	8/29/2016	PM	ND(0.5)	ND(0.5)	ND(0.5)	ND(0.5)	ND(0.5)	ND(0.5)	ND(0.5)	ND(0.5)	ND(0.5)	ND(25)
M36P122LNA	3627A Southside Ave	9/13/2016	PE	ND(0.5)	ND(0.5)	ND(0.5)	ND(0.5)	ND(0.5)	ND(0.5)	ND(0.5)	ND(0.5)	ND(0.5)	ND(25)
M36P122LNA	3627A Southside Ave	9/13/2016	PI	41	0.2 J	0.1 J	ND(0.5)	ND(0.5)	ND(0.5)	0.2 J	0.6	2.7	ND(25)
M36P122LNA	3627A Southside Ave	9/13/2016	PM	ND(0.5)	ND(0.5)	0.1 J	ND(0.5)	ND(0.5)	ND(0.5)	ND(0.5)	ND(0.5)	ND(0.5)	ND(25)

Notes:

ND(0.50) - not detected at or above the laboratory reporting limit, laboratory reporting limit included

Private Supply Well Analytical Data Table: 3627A Southside Avenue
 Inactive Exxon Facility #28077
 14258 Jarrettsville Pike
 Phoenix, MD

Map/Parcel/Lot	Address	Sample Date	POET Sample Point	MTBE (µg/L)	Benzene (µg/L)	Toluene (µg/L)	Ethyl-Benzene (µg/L)	Total Xylenes (µg/L)	Naphthalene (µg/L)	DIPE (µg/L)	ETBE (µg/L)	TAME (µg/L)	TBA (µg/L)
----------------	---------	-------------	-------------------	-------------	----------------	----------------	----------------------	----------------------	--------------------	-------------	-------------	-------------	------------

µg/L - micrograms per liter (parts per billion)

BTEX - benzene, toluene, ethylbenzene, and total xylenes

DIPE - di-isopropyl ether

ETBE - ethyl tert butyl ether

MTBE - methyl tertiary butyl ether

POET - Point of Entry Treatment System

TAME - tert-amyl methyl ether

TBA - tert butyl alcohol

PEO - Effluent Sample Location. POET installed/maintained by Owner

PIO - Influent Sample Location. POET installed/maintained by Owner

PE - Effluent Sample Location. POET installed/maintained by EMES

PI - Influent Sample Location. POET installed/maintained by EMES

PM - Midfluent Sample Location. POET installed/maintained by EMES

Carbon Change-out completed on 12/19/2013